

HIGHWAYS AT CARLISLE IN THE CITY OF CARLISLE

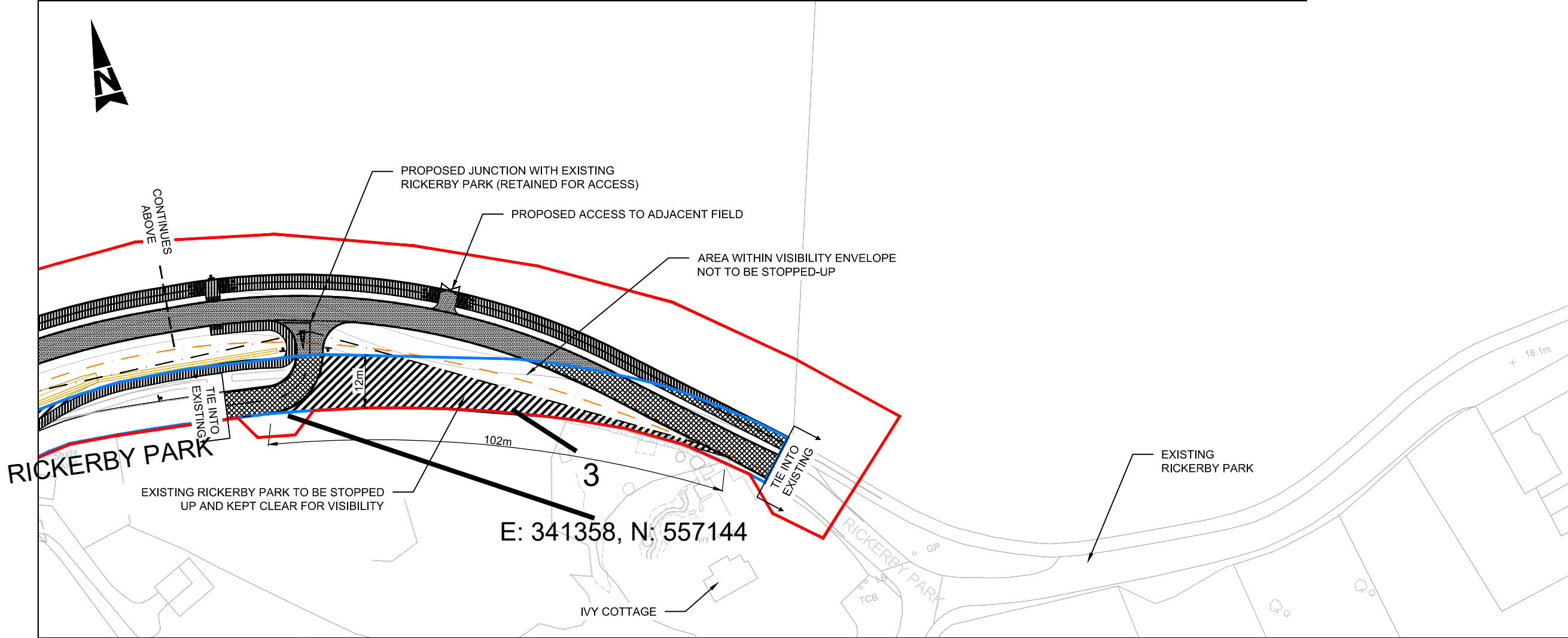
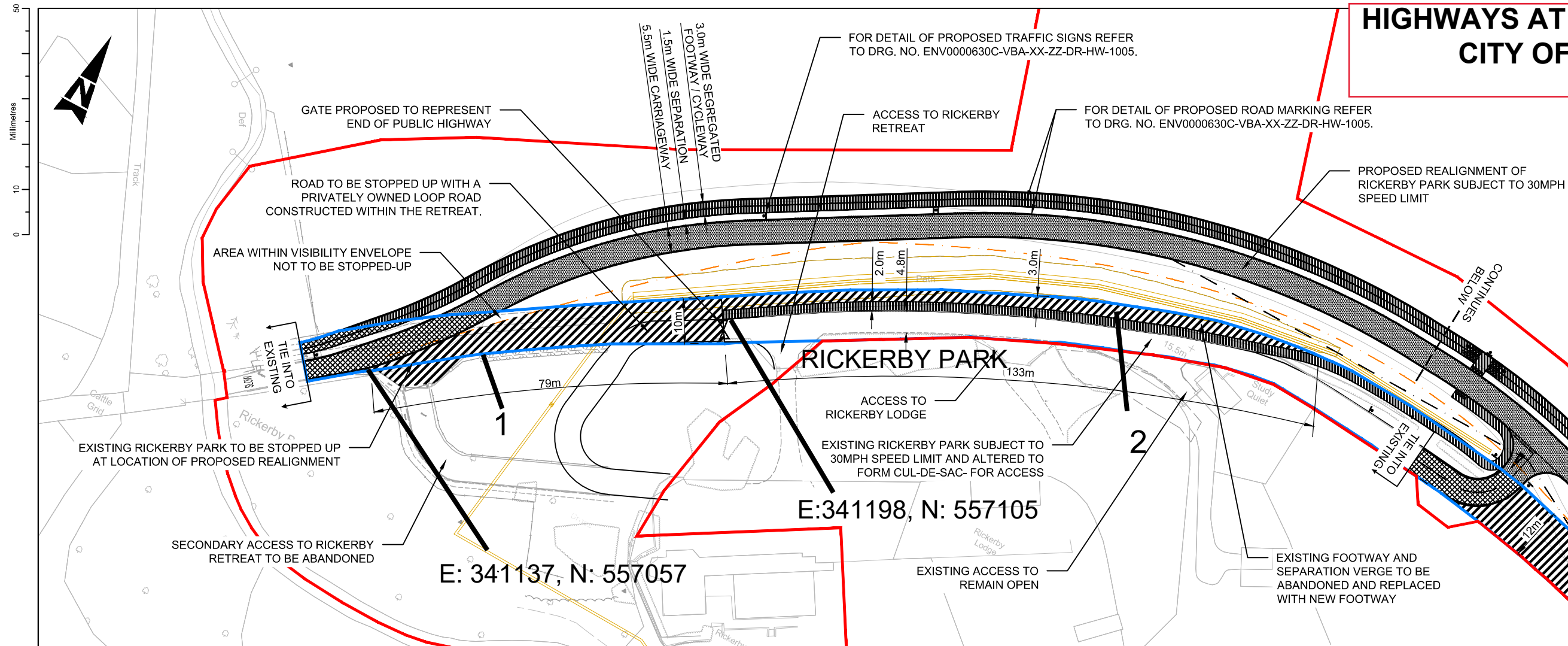

Key **Scale** 1:1000 @ A3

Highways to be stopped up [Hatched pattern]

Proposed highways to be improved [Cross-hatched pattern]

Proposed new highways [Dotted pattern]

Proposed Footway/cycleway to be provided [Vertical lines pattern]

National Transport Casework Team

Department for Transport

Plan No: NATTRAN/NW/S247/3770

Signed by Authority of the Secretary of State

on **2019**

Signature

DAVE CANDLISH
An Official in the
National Transport Casework Team
Department for Transport